

Steel Sliding Roof Type 2 **A12.1**

Removing and installing steel sliding roof

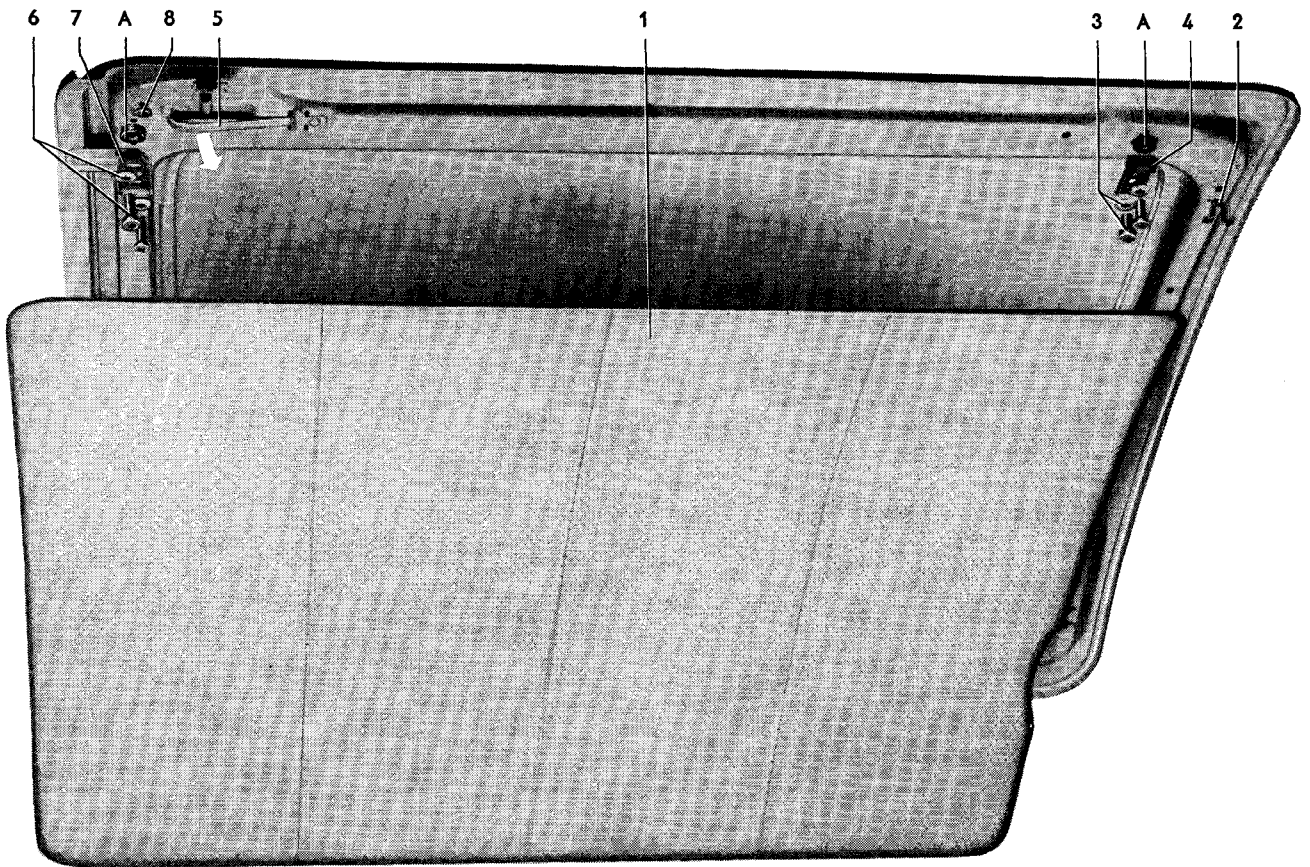

No.	Designation	Qty.	When		see page
			removing	installing	
1	Trim panel	1			
2	Clips for trim panel	5		check, replace if necessary	
3	Phillips screw with spring washer	4		check, replace if necessary, oil lightly	
4	Front guide	2			
5	Leaf spring	2	see special instructions		
6	Philips screw with spring washer	4		check, replace if necessary, oil lightly	
7	Rear guide	2			
8	Plug for panel	2			
A	Height adjusting screw	4			A 12.1/1-8

A12.1 Steel Sliding Roof Type 2

Special instructions:

Removing

- 1 - Open roof slightly.
- 2 - Detach trim panel (1) from sliding roof at front.

Note:

This should be done by inserting a screwdriver carefully between trim panel and sliding roof and pressing the five clips (2) out by levering with the screwdriver.

- 3 - Push trim panel to rear as far as it will go.
- 4 - Close roof until it is only open about two inches.
- 5 - Remove both front guides (4).
- 6 - Unhook the leaf springs (5) on each of the rear guides and swing them inwards.
- 7 - Pull left and right guides — at the rear on the cables — out of the brackets on the roof and turn them down.
- 8 - Lift sliding roof panel out of roof opening carefully, taking care not to damage the seal.

Installing

- 1 - Place sliding roof panel in roof opening at an angle.
- 2 - Push panel to rear and lower the front end slowly.
- 3 - Pull sliding panel to the front.
- 4 - Press the left and right guides — at the rear on the cables — into the brackets on the sliding roof and hook leaf springs into position.
- 5 - Install front guides.
- 6 - Adjust sliding roof (see section on “Adjusting cables” and “Adjusting height of sliding roof”).
- 7 - Open roof halfway and pull trim panel forward.
- 8 - Attach trim panel to roof by pressing the clips in.

Removing and installing sliding roof trim panel

The trim panel can only be removed and installed when the sliding roof is removed.

Removing

- 1 - Open roof slightly.
- 2 - Detach trim panel from roof at front.
Note:
This should be done by inserting a screwdriver carefully between trim panel and sliding roof and pressing the five clips out by levering with the screwdriver.
- 3 - Push trim panel to rear as far as it will go.
- 4 - Remove sliding roof — A 12.1/1-1.
- 5 - Remove left-hand runner.
- 6 - Pull runner and rear retainer out of bracket and lift it out.
- 7 - Take trim panel out of roof opening carefully.

Installing

Dirty trim panels can be cleaned with plastic cleaner R 3.

- 1 - Check frame, trim panel and steel clips and replace parts as necessary.
- 2 - Place trim panel in the runners.
- 3 - If necessary, straighten the trim panel frame before attaching it to the roof panel with the steel clips.

A12.1 Steel Sliding Roof Type 2

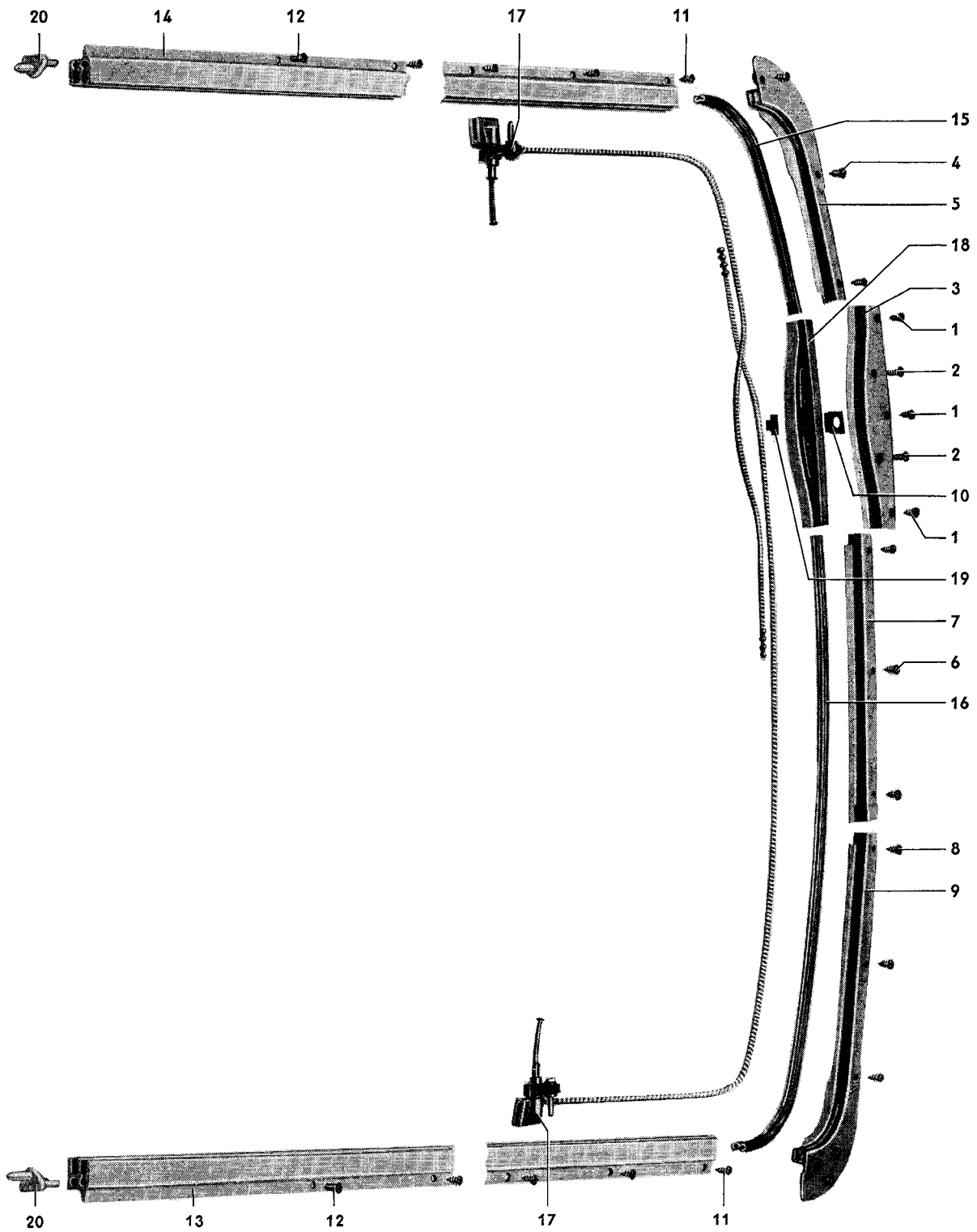

No.	Designation	Qty.	When		see page		
			removing	installing			
	Trim panel	1	remove	install	A 12.1/1-3		
	Sliding roof	1	remove	install	A 12.1/1-1		
1	Phillips screw	3	see special instructions				
2	Csk. hd. screw	2					
3	Cover for center guide	1				check, replace if necessary	
4	Phillips screw	3					
5	Runner, upper part front, left	1					
6	Phillips screw	3					
7	Runner, upper part front, center	1					
8	Phillips screw	4					
9	Runner, upper part front, right	1					
10	Spring plate, center runner	1					
11	Phillips screw	8/8					
12	Csk. hd. screw M 4x12	1/1					
13	Runner, right	1					
14	Runner, left	1					
15	Runner, lower part front left	1				check for wear, distortion and damage. Replace parts as necessary. To ensure that the roof runs parallel it is advisable to fit two new cables even if only one is damaged.	
16	Runner, lower part front right	1					
17	Guide, left / right with cable	1/1					
18	Center cable guide	1					
19	Spreader pin	3					
20	Retainer for runner	2				check for tightness, replace if necessary	

Special instructions:

Removing

- 1 - Remove sliding roof.
- 2 - Remove three Phillips screws (1) and two countersunk head screws (2) holding cover for center guide (3) and take cover off.
- 3 - Remove three screws (6) in center upper runner (7) and take upper part of runner off.
- 4 - Remove three screws (4) in left upper runner (5) and take upper part of runner off.
- 5 - Remove four screws (8) in right upper runner (9) and take upper part of runner off.
- 6 - Remove spring plate for center runner (10).
- 7 - Remove 16 Phillips screws (11) and two countersunk head screws (12) in left and right runners (13/14) and take runners and rear retainers (20) out of the brackets.
- 8 - Remove center runner (18).
- 9 - Pull cable guides off runners.

Caution

When removing these parts take care not to damage the paint on the roof.

Installing

- 1 - Place runners and guides with cables in the sliding roof opening.

The plastic retainers (20) must fit properly in the brackets.

If they do not do so, the runners can move sideways when the roof is opened and closed and the roof will not work smoothly.

- 2 - Before securing the runners, place the trim panel in the grooves in the runners and push it to the rear as far as it will go.
- 3 - Secure both side runners.
- 4 - Install center cable guide in roof opening.
- 5 - Install left, right and center runner upper parts.
- 6 - Install sliding roof and adjust it to run parallel.

Adjusting cables

- 1 - Detach trim panel and push it to the rear. Close roof again.
- 2 - Remove crank and escutcheon.
- 3 - Undo the screws holding the drive gear about six turns.
- 4 - Pull drive gear down until the gear no longer engages the cables.
- 5 - Check position of sliding roof in roof opening and rectify if necessary. This brings the cables into a parallel, free-of-tension position.
- 6 - Place the lifters of the rear guides in a vertical position and adjust the height (see section on adjusting height of sliding roof).
- 7 - Turn drive gear shaft to the right as far as it will to then turn it back half a turn.
- 8 - Press drive gear up again and tighten screws. Make sure that the gear engages in both cables properly.
- 9 - Install escutcheon and crank.

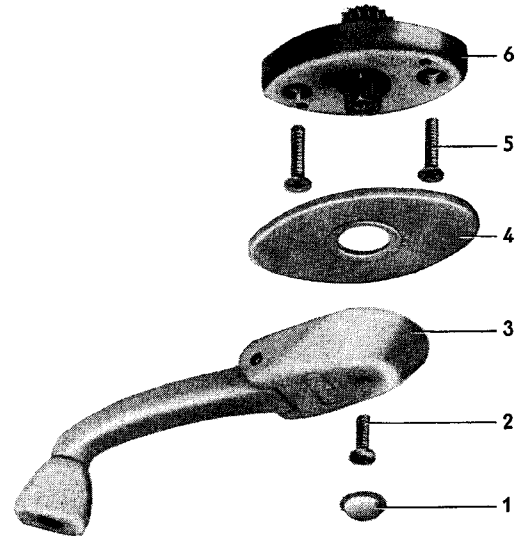

- 1 - Cap
- 2 - Screw
- 3 - Crank
- 4 - Escutcheon
- 5 - Screw
- 6 - Cable drive gear

- 10 - Check cable adjustment and crank position by opening and closing the roof a few times. Repeat adjustment if necessary. Then pull trim panel forward and attach it to roof panel.

A12.1 Steel Sliding Roof Type 2

Adjusting height of sliding roof

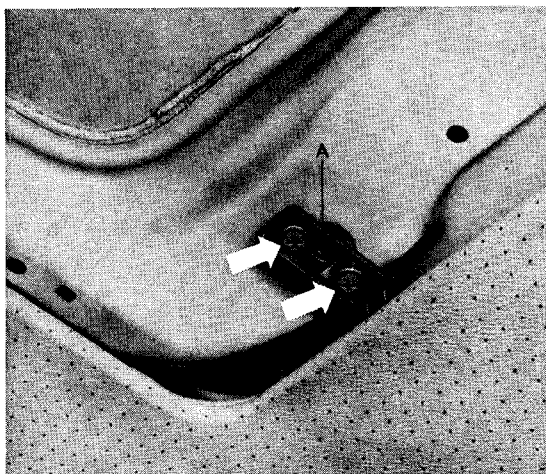

A = Adjusting screw

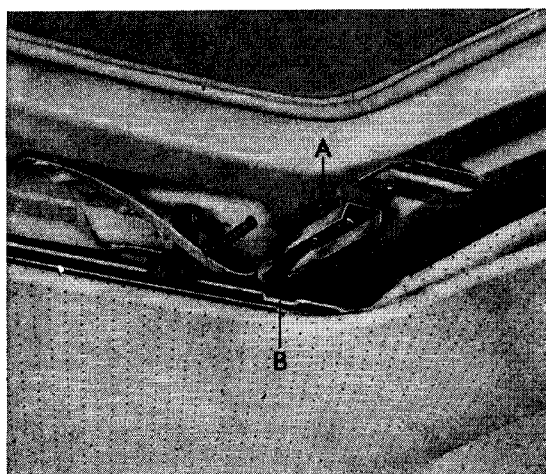
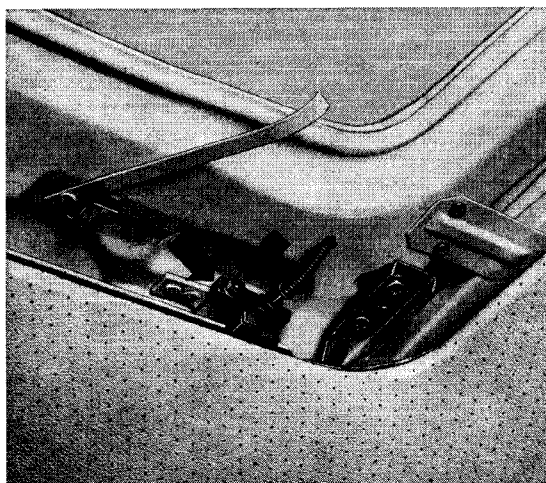

A = Adjusting screw
B = Recess in runner

Front

- 1 - Open roof slightly, detach trim panel and push it to the rear. Close roof.
- 2 - Loosen two screws in both front guides (arrows).
- 3 - Adjust height of panel by turning the adjusting screw (A) on each side.
- 4 - Tighten the guide securing screws again.

Rear

- 1 - Open roof slightly, unhook leaf spring and swing it to side.
- 2 - Loosen hexagon nut and screw (arrows).
Correct the height by moving the lifter pin in elongated hole.
- 3 - Tighten nut and screw again and hook the leaf spring in.
- 4 - By turning the screw (A) above the rear guide on each side, adjust the height of the rear guide so that it fits in the recess when the roof is opening and closing.

Note:

The rear guide prevents the sliding roof from bouncing about, using the front guides as pivots, when the vehicle is driving over rough roads.

- 5 - Tighten the securing screws in the rear guides.
- 6 - Check that roof panel runs parallel. Adjust cables if necessary (see section on adjusting sliding roof cables).
- 7 - Pull trim panel forward and attach it to roof.

Sliding roof sealing

The sliding roof is sealed all round with a special seal (velvet strip).

The ridge on the seal must be inwards when seal is being stuck on. Proceed as follows:

Coat seal and edge of roof opening with D 12 adhesive.

At the rear of the opening the folded edge of the roof must also be coated with adhesive.

Place seal loosely in water drain channel. The joint should be in the center at the rear of the roof opening.

Start to stick the seal on in the center of the front edge of opening. Ensure that the seal does not project above the edge of the roof opening. In the corners of the roof opening the seal must be stuck on very carefully so that it will not be torn off when roof is opened and closed. At the rear of the roof opening the seal flange must be pressed round the folded edge. The seal must be cut so that the joint is completely leakproof.

Water drainage

Water which enters the roof opening runs along channels in the roof frame and drains away through hoses fitted at the front, center and rear of the drain channels.

If the drain hoses get blocked, the front ones can be cleaned from above, after opening the sliding roof and the rear ones from underneath, after removing the valves. A flexible steel wire such as an old speedometer cable can be used for this purpose.

When installing new drain hoses, ensure that they are not kinked. It is advisable to coat the inside of the hoses with D 12 adhesive before installing them.